

**NorDan UK Ltd**

3 Almondview Office Park
Livingston
EH54 6SF

Tel: 01506 433173

e-mail: info@nordan.co.uk

website: www.nordan.co.uk

**Agrement Certificate****07/4446**

Product Sheet 2

NORDAN TIMBER WINDOW RANGE**NORDAN FA AND TL FIXED WINDOWS**

This Agrément Certificate Product Sheet⁽¹⁾ relates to NorDan FA and TL Fixed Windows, for use in new and existing dwellings, light commercial premises or similar habitable applications. The range comprises fixed windows constructed from timber coated with microporous paint or, as an option, externally clad with powder-coated aluminium panels and glazed with sealed double-glazed units⁽²⁾.

(1) Hereinafter referred to as 'Certificate'.

(2) Outside the scope of this Certificate.

CERTIFICATION INCLUDES:

- factors relating to compliance with Building Regulations where applicable
- factors relating to additional non-regulatory information where applicable
- independently verified technical specification
- assessment criteria and technical investigations
- design considerations
- installation guidance
- regular surveillance of production
- formal three-yearly review.

**KEY FACTORS ASSESSED**

Thermal properties — the thermal transmittance (U value) of a window from within the range was calculated as $1.3 \text{ W}\cdot\text{m}^{-2}\cdot\text{K}^{-1}$ (see section 6).

Weathertightness — the system can be used in the exposure situations described in this Certificate (see section 7).

Unauthorised access — windows from within the range can contribute to preventing unauthorised access to dwellings and similar habitable applications (see section 9).

Durability — the windows will have a service life of at least 25 years subject to the necessary maintenance being performed (see sections 13 and 14).



The BBA has awarded this Certificate to the company named above for the system described herein. This system has been assessed by the BBA as being fit for its intended use provided it is installed, used and maintained as set out in this Certificate.

On behalf of the British Board of Agrément

Hardy Giesler
Chief Executive Officer

Date of Fourth issue: 8 June 2020

Originally certificated on 18 June 2007

*The BBA is a UKAS accredited certification body – Number 113.**The schedule of the current scope of accreditation for product certification is available in pdf format via the UKAS link on the BBA website at www.bbacerts.co.uk**Readers MUST check the validity and latest issue number of this Agrément Certificate by either referring to the BBA website or contacting the BBA directly.**Any photographs are for illustrative purposes only, do not constitute advice and should not be relied upon.***British Board of Agrément**

Bucknalls Lane
Watford
Herts WD25 9BA

tel: 01923 665300
clientservices@bbacerts.co.uk
www.bbacerts.co.uk

©2020



Regulations

In the opinion of the BBA, NorDan FA and TL Fixed Windows, if installed, used and maintained in accordance with the provisions of this Certificate, will satisfy or contribute to satisfying the relevant requirements of the following Building Regulations (the presence of a UK map indicates that the subject is related to the Building Regulations in the region or regions of the UK depicted):



The Building Regulations 2010 (England and Wales) (as amended)

Requirement:	C2(b)	Resistance to moisture
Comment:		The system has adequate resistance to the ingress of rain and wind-driven spray and so can contribute to satisfying this Requirement. See section 7.2 of this Certificate.
Requirement:	C2(c)	Resistance to moisture
Comment:		The system will not constitute a significant condensation risk so can contribute towards the wall satisfying this Regulation. See section 11.1 of this Certificate.
Requirement:	L1(a)(i)	Conservation of fuel and power
Comment:		The windows can contribute to satisfying this Requirement. See section 6.1 of this Certificate.
Requirement:	Q1	Unauthorised access
Comment:		The windows as described in the additional Enhanced Security (ES2) for Product Sheet 2, can satisfy this Requirement for new dwellings. See section 9.1 of this Certificate.
Regulation:	7(1)	Materials and workmanship
Comment:		The system is acceptable. See sections 14.1 to 14.3 and the <i>Installation</i> part of this Certificate.
Regulation:	26	CO₂ emission rates for new buildings
Regulation:	26A	Fabric energy efficiency rates for new dwellings (applicable to England only)
Regulation:	26A	Primary energy consumption rates for new buildings (applicable to Wales only)
Regulation:	26B	Fabric performance values for new dwellings (applicable to Wales only)
Comment:		The system can contribute to satisfying these Regulations. See section 6.1 of this Certificate.



The Building (Scotland) Regulations 2004 (as amended)

Regulation:	8(1)(2)	Durability, workmanship and fitness of materials
Comment:		The system satisfies this Regulation. See sections 13 and 14.1 to 14.4 and the <i>Installation</i> part of this Certificate.
Regulation:	9	Building Standards applicable to construction
Standard:	3.10	Precipitation
Comment:		The system has adequate resistance to the ingress of rain and wind-driven spray and so can contribute to satisfying this Standard, with reference to clause 3.10.1 ⁽¹⁾⁽²⁾ . See section 7.2 of this Certificate.
Standard:	3.15	Condensation
Comment:		The system will not constitute a significant condensation risk and so can contribute towards the wall satisfying this Standard, with reference to clauses 3.15.1 ⁽¹⁾⁽²⁾ , 3.15.4 ⁽¹⁾⁽²⁾ and 3.15.5 ⁽¹⁾⁽²⁾ . See section 11.1 of this Certificate.
Standard:	3.16	Natural lighting
Comment:		The system can contribute to satisfying this Standard, with reference to clauses 3.16.1 ⁽¹⁾ and 3.16.3 ⁽¹⁾ . See section 10 of this Certificate.



Standard: Comment:	4.13	Security The windows as described in the Enhanced Security Sheet (ES2) for Product Sheet 2, can satisfy this Standard, with reference to clause 4.13.1(c) ⁽¹⁾ . See section 9.1 of this Certificate.
Standard: Standard: Comment:	6.1(b) 6.2	Carbon dioxide emissions Building insulation envelope The system can contribute to satisfying these Standards, with reference to clauses 6.1.1 ⁽¹⁾ , 6.1.2 ⁽¹⁾ , 6.1.4 ⁽²⁾ , 6.1.6 ⁽¹⁾ , 6.1.7 ⁽¹⁾ , 6.2.1 ⁽¹⁾⁽²⁾ , 6.2.4 ⁽²⁾ , 6.2.6 ⁽¹⁾ , 6.2.7 ⁽¹⁾ , 6.2.8 ⁽²⁾ , 6.2.9 ⁽¹⁾⁽²⁾ , 6.2.11 ⁽¹⁾⁽²⁾ and 6.2.13 ⁽¹⁾⁽²⁾ . See section 6.1 of this Certificate.
Standard: Comment:	7.1(a)(b)	Statement of sustainability The system can contribute to satisfying the relevant requirements of Regulation 9, Standards 1 to 6, and therefore will contribute to a construction meeting a bronze level of sustainability as defined in this Standard. In addition, the system can contribute to a construction meeting a higher level of sustainability as defined in this Standard, with reference to clauses 7.1.4 ⁽¹⁾⁽²⁾ [Aspects 1 ⁽¹⁾⁽²⁾ and 2 ⁽¹⁾], 7.1.6 ⁽¹⁾⁽²⁾ [Aspects 1 ⁽¹⁾⁽²⁾ and 2 ⁽¹⁾] and 7.1.7 ⁽¹⁾⁽²⁾ [Aspect 1 ⁽¹⁾⁽²⁾]. See section 6.1 of this Certificate.
Regulation: Comment:	12	Building standards applicable to conversions All comments given for the system under Regulation 9, Standards 1 to 6, also apply to this Regulation, with reference to clause 0.12.1 ⁽¹⁾⁽²⁾ and Schedule 6 ⁽¹⁾⁽²⁾ . (1) Technical Handbook (Domestic). (2) Technical Handbook (Non-Domestic).



The Building Regulations (Northern Ireland) 2012 (as amended)

Regulation: Comment:	23	Fitness of materials and workmanship The system is acceptable. See sections 14.1 to 14.3 and the <i>Installation</i> part of this Certificate.
Regulation: Comment:	28(b)	Resistance to moisture and weather The system has adequate resistance to the ingress of rain and wind-driven spray and so can contribute to satisfying this Regulation. See section 7.2 of this Certificate.
Regulation: Comment:	29	Condensation The system will not constitute a significant condensation risk and so can contribute towards the wall satisfying this Regulation. See section 11.1 of this Certificate
Regulation: Regulation: Comment:	39(a)(i) 40(2)	Conservation measures Target carbon dioxide emission rate The system can contribute to satisfying these Regulations. See section 6.1 of this Certificate.

Construction (Design and Management) Regulations 2015 Construction (Design and Management) Regulations (Northern Ireland) 2016

Information in this Certificate may assist the client, designer (including Principal Designer) and contractor (including Principal Contractor) to address their obligations under these Regulations.

See sections: 3 *Delivery and site handling* (3.3) and 12 *Safety* (12.3 and 12.4) of this Certificate.



Additional Information

NHBC Standards 2020

In the opinion of the BBA, NorDan FA and TL Fixed Windows, if installed, used and maintained in accordance with this Certificate, can satisfy or contribute to satisfying the relevant requirements in relation to *NHBC Standards*, Chapter 6.7 *Doors, windows and glazing*.

CE marking

The Certificate holder has taken the responsibility of CE marking the products in association with harmonised standard BS EN 14351-1 : 2006.

Technical Specification

1 Description

1.1 NorDan FA and TL Fixed Windows (see Figure 1) are manufactured from preserved North European Redwood, factory finished painted or externally clad in aluminium with a polyester powder coating in any standard RAL colour. Windows can be supplied uncoated on request and subject to the Certificate holder's approval, but the durability of these windows has not been assessed.

Figure 1 Corner detail

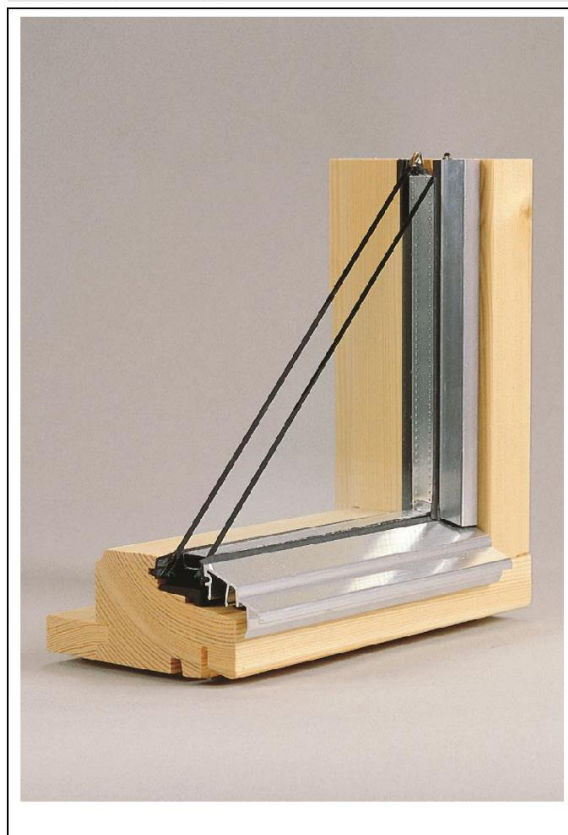

1.2 Windows comprise single, fixed lights as shown in Figures 2 and 3 and fixed-light windows in multilight combinations subject to the size restrictions shown in Table 1.



<i>Table 1 Size restrictions</i>	
Feature	Dimension (mm)
Individual fixed light	1185 high x 1185 wide
Multilights:	
Maximum overall height of outer frame	2488
Maximum overall width of outer frame	2488
Multilight fixed lights up to a maximum size	
cruciform 62 mm mullion and 62 mm transom	2488 high x 2488 wide
62 mm transom only	1988 high x 2488 wide
92 mm transom only	1988 high x 2488 wide

1.3 Multilight windows can be made up of fixed lights, mechanically coupled together, or by using a mullion or transom glued and nailed into the outer frame with a mortise and tenon joint.

1.4 Framing members comprise profiled, North European Redwood sections formed by cutting the required profiles from engineered timber. After profiling and machining, the timber is preservative-treated using a vacuum-impregnation technique to EN 351-1 : 2007.

1.5 All windows are factory glazed using sealed double-glazed units⁽¹⁾ (see Figures 2 and 3).

(1) Outside the scope of this Certificate.

Figure 2 Typical vertical section (showing aluminium cladding)

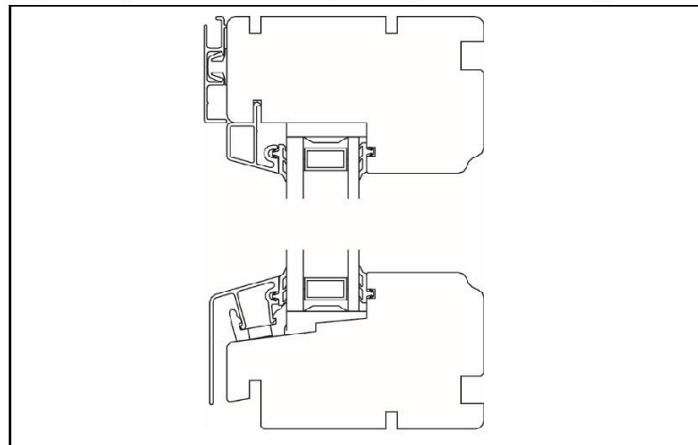
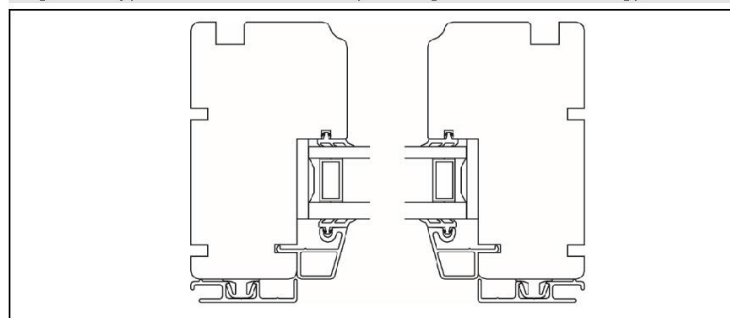

Figure 3 Typical horizontal section (showing aluminium cladding)





Glazing

1.6 Windows are supplied factory glazed using double-glazed units⁽¹⁾, with glass thicknesses in accordance with BS 6262-1 : 2017, comprising a 6 mm thick outer pane, an air-filled or argon-filled cavity of 16 mm and a 4 mm thick inner pane. Other types of glass units are available from the Certificate holder, but these have not been assessed.

(1) Outside the scope of this Certificate.

1.7 The glazing units must satisfy the requirements of BS EN 1279-2 : 2018 and (if relevant) BS EN 1279-3 : 2018.

1.8 Glazing units are sealed into the wooden frame using a polyurethane adhesive sealant.

1.9 Glazing beads are manufactured from aluminium and are polyester powder coated in any standard RAL colour.

1.10 NHBC require⁽¹⁾ that compliance to the Standards referred to in sections 1.6 and 1.7 is confirmed by an appropriate independent technical approvals authority.

(1) *NHBC Standards 2020, Chapter 6.7.7, Glazing, insulating glass units.*

2 Manufacture

2.1 NorDan FA and TL Fixed Windows are manufactured from preserved North European Redwood, formed by cutting the required profiles from engineered timber and factory finished painted or externally clad in aluminium with a polyester powder coating in any standard RAL colour.

2.2 As part of the assessment and ongoing surveillance of product quality, the BBA has:

- agreed with the manufacturer the quality control procedures and product testing to be undertaken
- assessed and agreed the quality control operated over batches of incoming materials
- monitored the production process and verified that it is in accordance with the documented process
- evaluated the process for management of nonconformities
- checked that equipment has been properly tested and calibrated
- undertaken to carry out the above measures on a regular basis through a surveillance process, to verify that the specifications and quality control operated by the manufacturer are being maintained.

2.3 The management system of the manufacturer has been assessed and registered as meeting the requirements of BS EN ISO 9001 : 2015 by Nemko Certification AS (Certificate 800003).

3 Delivery and site handling

3.1 The windows are delivered to site ready glazed. For transportation, they are set securely on timber pallets which are then factory shrink-wrapped and steel-banded to provide protection against surface damage. Care must be taken during all subsequent site handling processes to avoid the risk of damage. Each window is marked with the customer's reference production serial number and glass size and make-up for easy identification on site.

3.2 The windows should be stored in accordance with the Certificate holder's recommendations.

3.3 The weight of the unglazed frame and of the glazing (which can be obtained from the Certificate holder) and their ease of handling, particularly by one person, must also be taken into account when planning site operations.

Assessment and Technical Investigations

The following is a summary of the assessment and technical investigations carried out on NorDan FA and TL Fixed Windows.



Design Considerations

4 Use

NorDan FA and TL Fixed Windows are satisfactory for use in non-loadbearing applications where windows are installed vertically into the external walls of new and existing dwellings, light commercial premises and similar habitable applications.

5 Practicability of installation

The windows are designed to be installed by a competent general builder, or a contractor, experienced with this type of system.

6 Thermal properties



6.1 The thermal transmittance value (U value) of a window, 1220 mm wide by 1480 mm high, incorporating a tilt and turn opening light and a fixed-light, and glazed as described in section 1.6, when calculated according to BS EN ISO 10077-1 : 2017 and BS EN ISO 10077-2 : 2017, is $1.3 \text{ W}\cdot\text{m}^{-2}\cdot\text{K}^{-1}$.

6.2 The overall thermal insulation of the window will be dependent on the performance of the double-glazed units. For units other than that described in section 6.1, the indicative U values shown in Table 6e of SAP 2012 *The Government's Standard Assessment Procedure for Energy Rating of Dwellings* can be used. When available, a certified U value by measurement to BS EN ISO 12567-1 : 2010, or calculation to BS EN ISO 10077-1 : 2017 and BS EN ISO 10077-2 : 2017, should be used in preference.

6.3 Design U values are detailed in the documents supporting the national Building Regulations.

7 Weathertightness

7.1 Selected samples from the NorDan FA and TL Fixed Windows were tested for weathertightness in accordance with BS EN 14351-1 : 2006, EN 1026 : 2016, EN 1027 : 2016 and EN 12211 : 2016, and are suitable for use as indicated in Table 2 of this Certificate. The classifications are based on the assumption that the outer frame is supported on all four sides in accordance with the Certificate holder's instructions.

Table 2 Weathertightness classifications

Window style	Classification according to:			
	Resistance to wind load according to BS EN 12210 : 2016	Watertightness according to BS EN 12208 : 2000	Air permeability according to BS EN 12207 : 2016	UK exposure category to BS 6375-1 : 2015
FA and TL Fixed Windows 1185 mm x 1185 mm	Class 3	Class 9A	Class 4	1200



7.2 The classifications in Table 2 can be used to determine suitability when selecting exposure category, in conjunction with Annex A of BS 6375-1 : 2015.

7.3 For unusual building layouts, building shapes or ground topography, the designer will need to give particular consideration to the prevailing exposure conditions.



8 Ventilation

NorDan FA and TL Fixed Windows do not open but the background ventilation requirements of the documents supporting the various Building Regulations can be satisfied by the incorporation in the window of a suitably sized trickle ventilator⁽¹⁾.

(1) Outside the scope of this Certificate.

9 Unauthorised access



9.1 Windows as described in the Enhanced Security Sheet (ES2) for Product Sheet 2, have been tested in accordance with PAS 24 : 2016, Annex C, and can contribute to satisfying the regulatory requirements for unauthorised access in new dwellings in England and Wales, and new and existing dwellings in Scotland.

9.2 Externally fitted glazing beads can be removed but subsequent removal of the glass without breakage and noise is extremely difficult due to the glazing being additionally secured with polyurethane sealant.

10 Glass area



The approximate unobstructed glass area of the windows is determined by deducting from the overall width and height the appropriate frame dimensions. Typical profile dimensions can be obtained from the Certificate holder — examples are given in Table 3.

Table 3 Typical dimensions for determining unobstructed glass area

Window feature	Dimensions (mm)
Outer frame	56
Mullion or transom between fixed lights	62 or 92

11 Condensation risk



11.1 In normal domestic or similar applications, timber windows do not constitute a significant condensation risk when correctly installed.

11.2 Guidance on satisfactory design details is given in *Limiting thermal bridging and air leakage : Robust construction details for dwellings and similar buildings*, TSO 2002 and the *Accredited Construction Details*. Further information is contained in BRE Report BR 262 : 2002.

12 Safety

12.1 Reasonable provision must be made for safe means of access to clean both faces of the window in accordance with the documents supporting the national Building Regulations.

12.2 Transparent glazing, of which people may be unaware and with which they are likely to collide, must incorporate features which make it apparent. The documents supporting the national Building Regulations include ways of complying with this requirement.

12.3 The documents supporting the national Building Regulations, *NHBC Standards 2020*, and BS 6262-4 : 2018⁽¹⁾ make recommendations to ensure the safe performance of glazing. These include the use of safety glass complying with BS EN 12600 : 2002 in locations where accidental collision is likely. The windows can be supplied with toughened or laminated glazing units, but the performance of the glazing units is outside the scope of this Certificate.

(1) Dealing with the safety of people upon impact with the glazing.



12.4 When selecting means of access during the period of installation (for example, use of scaffolding), the safety of operatives, occupants and passers-by should be considered.

13 Maintenance



13.1 The windows can be re-glazed. If the gasket is damaged on a glazing bead (for example, during re-glazing), the gasket may be replaced. These operations should be carried out by specialist operatives using the materials recommended by the Certificate holder and approved by the BBA.

13.2 The seal to the building structure will need to be replaced within the life of the window.

13.3 The painted coating/polyester powder coating can be cleaned using a soft sponge and soapy water. Solvent-based, corrosive or abrasive cleaners must not be used. If dirt is allowed to build up on the coating over long periods, it may become more difficult to restore the surface appearance.

13.4 Care should be taken when using proprietary materials for cleaning the glass, to ensure that deposits are not allowed to remain on the frames where they may cause discoloration and damage to the surface. In addition, care must be taken to avoid damage to, or discoloration of, the members when stripping paint from adjacent timber (for example, by means of a blowlamp or paint stripper).

13.5 If damage occurs to the painted coating, repairs should be carried out as described in the Certificate holder's instructions using paints⁽¹⁾ recommended by the Certificate holder.

{1} Outside the scope of this Certificate.

14 Durability



14.1 The windows will have a service life of at least 25 years, subject to the necessary maintenance being carried out as described in section 15 of this Certificate. This may be extended to up to 60 years for the coloured coating system, provided that it is regularly overcoated in accordance with section 16.3 of this Certificate.

14.2 The timber members of the frame are preservative pre-treated with an effective fungicide to EN 351-1 : 2007.

14.3 The coloured coating system used on the wooden surfaces has good chemical resistance and colour stability and will retain its appearance for at least 10 years without redecoration. The coating adheres well to the substrate and will retain its integrity for a similar period. The coating, however, may need to be repainted within this period using paints⁽¹⁾ recommended by the Certificate holder.

{1} Outside the scope of this Certificate.



14.4 The gaskets may need to be replaced within the life of the window.

14.5 Any slight colour change or surface dulling of the painted coating which might occur will be uniform over the visible surfaces of the windows.

15 Reuse and recyclability

The timber frame members and aluminium cladding sections of the system can be recycled.



Installation

16 General

16.1 The window must be fixed into the opening in accordance with the Certificate holder's installation instructions and BS 8213-4 : 2016, using appropriate fixing screws and/or proprietary expanding anchors through the frame or galvanized steel fixing lugs.

16.2 Openings in new walls should be formed, making suitable allowance for fitting tolerances. As details may vary depending on the type of construction being employed, tolerances should be discussed with the Certificate holder prior to establishing the manufacturing dimensions for the window.

16.3 In common with other types of windows fitted to prepared openings, the system must be correctly positioned in relation to damp-proof courses to prevent water penetration to the internal reveal.

16.4 The provision of a cavity closer and/or cavity barrier around the window opening, prior to the installation, may be required. Details of products covered by an Agrément Certificate can be found on the BBA website (www.bbacerts.co.uk).

Technical Investigations

17 Tests

17.1 Tests were carried out and the results assessed to determine:

- air permeability
- watertightness
- effect of wind loads
- basic security
- enhanced security.

17.2 Tests on windows were carried out generally in accordance with BS 644 : 2012.

17.3 The coatings on the timber profiles and aluminium cladding sections were tested to determine:

- colour stability
- coating thickness
- water absorption
- cross-cut adhesion.

18 Investigations

18.1 The thermal transmittance values of NorDan ND 3-Handled Tilt and Turn Inward Opening next to FA and TL Fixed Windows were calculated in accordance with BS EN ISO 10077-1 : 2017 and BS EN ISO 10077-2 : 2017.

18.2 The manufacturing process was evaluated, including the methods adopted for quality control, and details were obtained of the quality and composition of the materials used.



Bibliography

- BRE Report BR 262 : 2002 *Thermal Insulation : avoiding risks*
- BS 644 : 2012 *Timber windows and doorsets — Fully finished factory-assembled windows and doorsets of various types — Specification*
- BS 6262-1 : 2017 *Glazing for buildings — General methodology for the selection of glazing*
BS 6262-4 : 2018 *Glazing for buildings — Code of practice for safety related to human impact*
- BS 6375-1 : 2015 + A1 : 2016 *Performance of windows — Classification for weathertightness and guidance on selection and specification*
- BS 8213-4 : 2016 *Windows and doors — Code of practice for the survey and installation of windows and external doorsets*
- BS EN 1279-2 : 2018 *Glass in building — Insulating glass units — Long term test method and requirements for moisture penetration*
BS EN 1279-3 : 2018 *Glass in building — Insulating glass units — Long term test method and requirements for gas leakage rate and for gas concentration tolerances*
- BS EN 12207 : 2016 *Windows and doors — Air permeability — Classification*
- BS EN 12208 : 2000 *Windows and doors — Watertightness — Classification*
- BS EN 12210 : 2016 *Windows and doors — Resistance to wind load — Classification*
- BS EN 12600 : 2002 *Glass in building — Pendulum test — Impact test method and classification for flat glass*
- BS EN 14351-1 : 2006 + A2 : 2016 *Windows and doors — Product standard, performance characteristics — Windows and external pedestrian doorsets*
- BS EN ISO 9001 : 2015 *Quality management systems — Requirements*
- BS EN ISO 10077-1 : 2017 *Thermal performance of windows, doors and shutters — Calculation of thermal transmittance — General*
BS EN ISO 10077-2 : 2017 *Thermal performance of windows, doors and shutters — Calculation of thermal transmittance — Numerical method for frames*
- BS EN ISO 12567-1 : 2010 *Thermal performance of windows and doors — Determination of thermal transmittance by hot box method — Complete windows and doors*
- EN 351-1 : 2007 *Durability of wood or wood-based products — Preservative-treated solid wood — Classification of preservative penetration and retention*
- EN 1026 : 2016 *Windows and doors — Air permeability — Test method*
- EN 1027 : 2016 *Windows and doors — Watertightness — Test method*
- EN 12211 : 2016 *Windows and doors — Resistance to wind load — Test method*
- PAS 24 : 2016 *Enhanced security performance requirements for doorsets and windows in the UK — External doorsets and windows intended to offer a level of security suitable for dwellings and other buildings exposed to comparable risk*



Conditions of Certification

19 Conditions

19.1 This Certificate:

- relates only to the product/system that is named and described on the front page
- is issued only to the company, firm, organisation or person named on the front page – no other company, firm, organisation or person may hold or claim that this Certificate has been issued to them
- is valid only within the UK
- has to be read, considered and used as a whole document – it may be misleading and will be incomplete to be selective
- is copyright of the BBA
- is subject to English Law.

19.2 Publications, documents, specifications, legislation, regulations, standards and the like referenced in this Certificate are those that were current and/or deemed relevant by the BBA at the date of issue or reissue of this Certificate.

19.3 This Certificate will remain valid for an unlimited period provided that the product/system and its manufacture and/or fabrication, including all related and relevant parts and processes thereof:

- are maintained at or above the levels which have been assessed and found to be satisfactory by the BBA
- continue to be checked as and when deemed appropriate by the BBA under arrangements that it will determine
- are reviewed by the BBA as and when it considers appropriate.

19.4 The BBA has used due skill, care and diligence in preparing this Certificate, but no warranty is provided.

19.5 In issuing this Certificate the BBA is not responsible and is excluded from any liability to any company, firm, organisation or person, for any matters arising directly or indirectly from:

- the presence or absence of any patent, intellectual property or similar rights subsisting in the product/system or any other product/system
- the right of the Certificate holder to manufacture, supply, install, maintain or market the product/system
- actual installations of the product/system, including their nature, design, methods, performance, workmanship and maintenance
- any works and constructions in which the product/system is installed, including their nature, design, methods, performance, workmanship and maintenance
- any loss or damage, including personal injury, howsoever caused by the product/system, including its manufacture, supply, installation, use, maintenance and removal
- any claims by the manufacturer relating to CE marking.

19.6 Any information relating to the manufacture, supply, installation, use, maintenance and removal of this product/system which is contained or referred to in this Certificate is the minimum required to be met when the product/system is manufactured, supplied, installed, used, maintained and removed. It does not purport in any way to restate the requirements of the Health and Safety at Work etc. Act 1974, or of any other statutory, common law or other duty which may exist at the date of issue or reissue of this Certificate; nor is conformity with such information to be taken as satisfying the requirements of the 1974 Act or of any statutory, common law or other duty of care.